

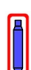





- | | | | | | | | | | |
|---|-------------------------------|---|---------------------|---|------------------------|---|------------------|---|-------------------------------------|
|  | Airbag |  | Gas generator |  | Seat belt pretensioner |  | SRS control unit |  | Active pedestrian protection system |
|  | Gas strut / Pre-loaded spring |  | Low-voltage battery |  | Petrol fuel tank | | | | |



1. Identification / recognition

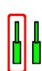
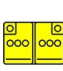

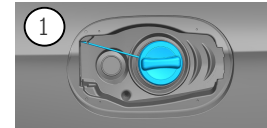
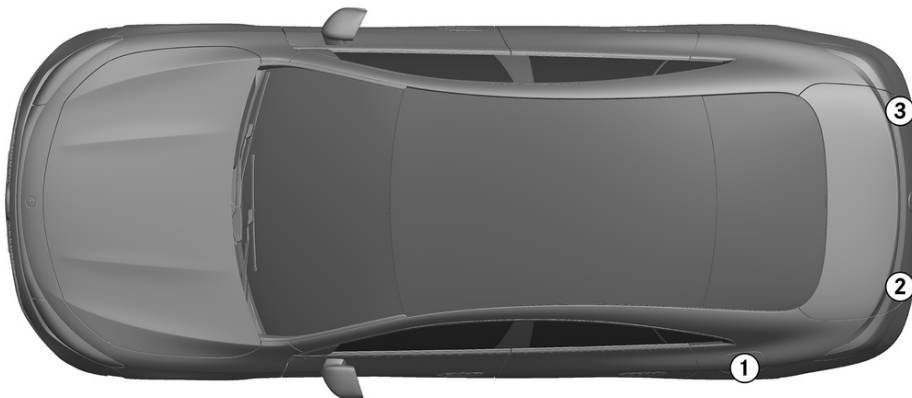
②
CLA 220

③
4MATIC

2. Immobilisation / stabilisation / lifting

Parking brake

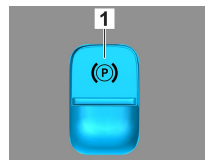
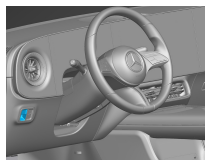
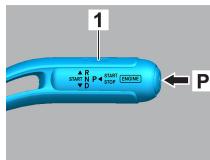
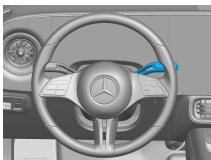

Press the P switch on the gear selector (1). The parking brake is automatically activated. Electric parking brake (1)

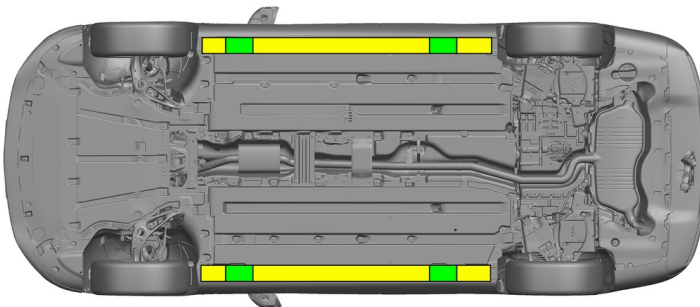

 Suitable lifting points

 Suitable stabilisation points on the side

3. Disable direct hazards / safety regulations

Switch off the ignition:

1. Switch off the ignition: Press "START/STOP" on the selector lever.
2. Keep the electronic vehicle key at a distance of at least 5 m.

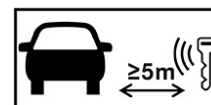

The absence of engine noise does not mean that the vehicle is switched off.



A restart is possible until the vehicle is switched off.



Disconnecting the 12 V battery

1. The 12 V battery is located in front of the center console under the instrument panel.
2. The battery is accessible by removing the floor covering in the footwell on the front passenger side.
3. Disconnect negative cable of 12 V battery at the threaded connection and secure against unintended contact.



The passive safety systems (airbags and seat belt pretensioners) are deactivated after disconnecting 12V battery.



10 seconds after disconnecting the 12V battery, the 48V system is automatically deactivated.



Disconnecting the 48 V battery

1. The 48-volt battery is located under the vehicle on the driver side.
2. Disconnect signal cable (1) from 48V battery.
3. Disconnect electrical cables (2) then (3) at the screw connection and secure it against unintentional contact.

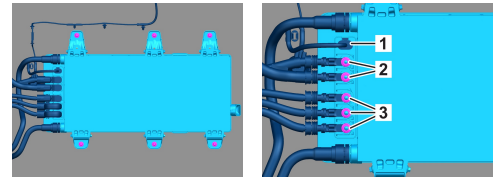

4. Access to the occupants

When rescuing the vehicle occupants, the components of the restraint systems (in particular pyrotechnic elements) must be taken into account in accordance with the information on page 1.

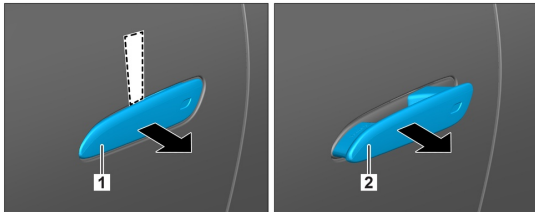

1. Slide a flat, non-metallic object behind the retracted door handle (1) from above and lever it slightly out. 2. Reach behind the door handle (2) from below and pull it out until you feel resistance, then hold.

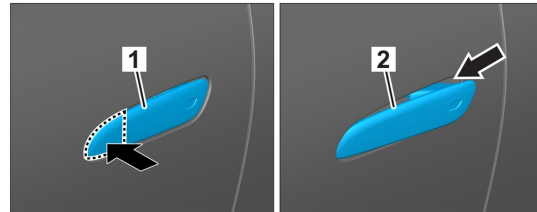

1. Press the front edge of the door handle 2. Pull the door handle outward

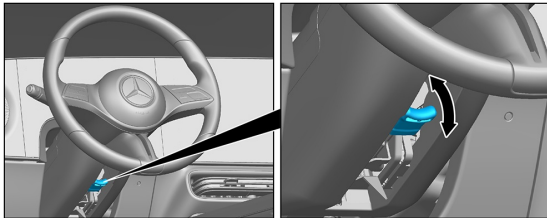

Steering wheel adjustment

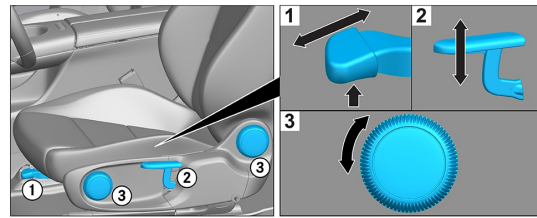

Seat adjustment (mechanical)

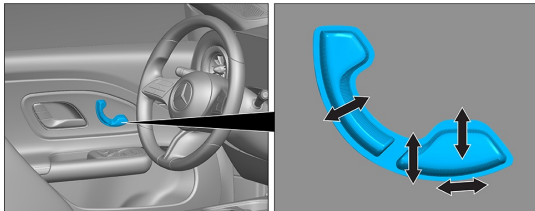

Seat adjustment (electric)

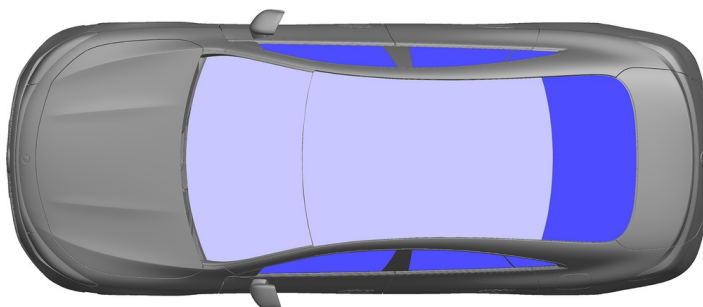

- VSG: Laminated safety glass
- ESG: Tempered glass



5. Stored energy / liquids / gases / solids

		48 V Li-ion
		12 V Li-ion
		51 L
		630 ± 10 g

6. In case of fire



Use large volumes of water (H₂O) to extinguish a vehicle fire.
Use large volumes of water (H₂O) to cool the Li-ion battery.



Warning: Ignition of the battery possible



7. In case of submersion

There is no risk of voltage in the bodywork. After recovery of the vehicle:

1. Allow the water to drain out of the interior.
2. Commence deactivation of the 12 V/48 V electrical system (see Section 3).

8. Towing / transportation / storage

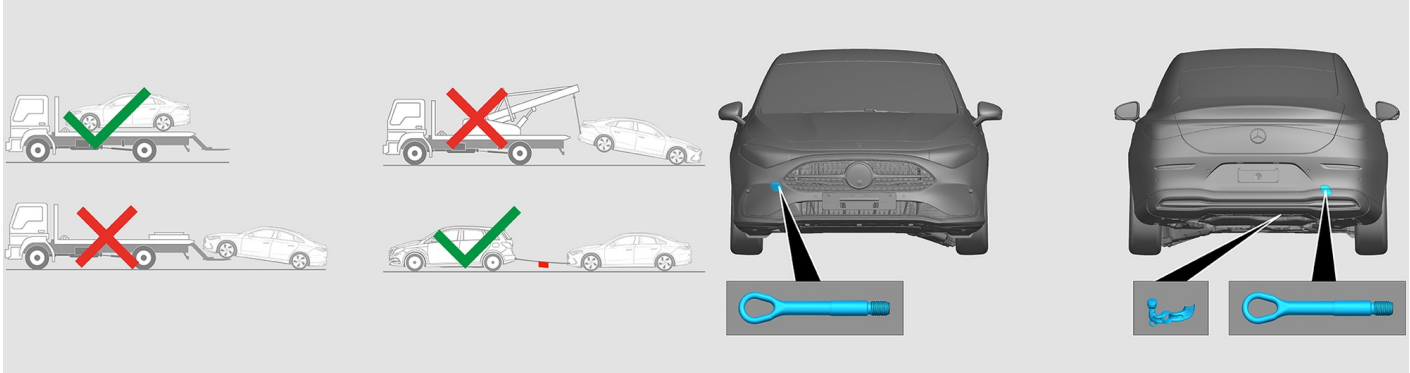

9. Important additional information

You can find more information in the [Guidelines for car towing services](#).

Note: Please see our [emergency response guide](#) for more information



10. Explanation of pictograms used



Vehicle on fuel of li-
quid group 2



General warning sign



Flammable



Hazardous to the hu-
man health



Corrosives



Acute toxicity



Explosive



Use water to extin-
guish the fire



Use dry foam to extin-
guish the fire



Use wet foam to ex-
tinguish the fire



Remove smart key



Air-conditioning com-
ponent



Warning; low temperat-
ure